

FUBAG DCF 1700

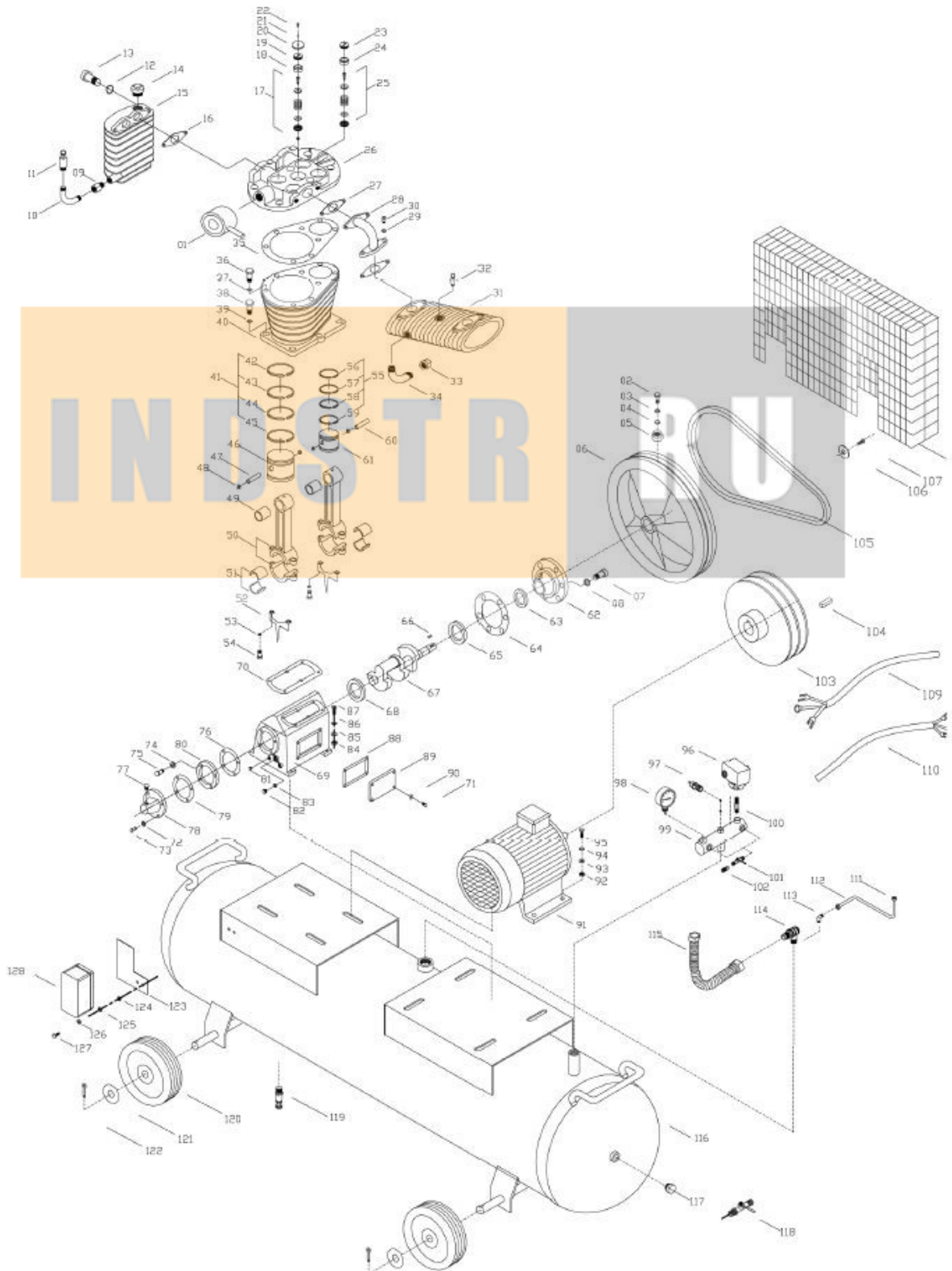

FUBAG DCF 1700 Parts List

REF #	PART #	DESCRIPTION	REF #	PART #	DESCRIPTION
1	HS2105T001	AIR FILTER	65	HS2105T065	BEARING
2	HS2105T002	FLYWHEEL BOLT	66	HS2105T066	WOODRUFF KEY
3	HS2105T003	SPRING WASHER	67	HS2105T067	CRANKSHAFT
4	HS2105T004	SPRING WASHER	68	HS2105T068	BEARING
5	HS2105T005	HEX NUT	69	HS2105T069	CRANKCASE
6	HS2105T006-1	FLYWHEEL (520MM)	70	HS2105T070	CYLINDER GASKET
7	HS2105T007	BOLT	71	HS2105T071	BOLT
8	HS2105T008	COPPER WASHER	72	HS2105T072	COPPER WASHER
9	HS2105T009	CONNECTOR	73	HS2105T073	BOLT
10	HS2105T010	SMALL ELBOW	74	HS2105T074	COPPER WASHER
11	HS2105T011	SAFETY VALVE	75	HS2105T075	BOLT
12	HS2105T012	COPPER WASHER	76	HS2105T076	FRONT COVER GASKET
13	HS2105T013	BOLT	77	HS2105T077	BREATHER
14	HS2105T014	BIG PLUG	78	HS2105T078	FRONT CASE
15	HS2105T015	AFTERCOOLER	79	HS2105T079	SHELL PAPER GASKET
16	HS2105T016	AFTERCOOLER GASKET	80	HS2105T080	CONNECTING PLATE
17	HS2105T017	INLET VALVE KIT	81	HS3090BT02	OIL PLUG 3/8
18	HS2105T018	GUIDE SEAT	82	HS3090BT04	OIL SIGHTGLASS
19	HS2105T019	VALVE CAP	83	HS3090BT03	OIL SIGHTGLASS SEAL
20	HS2105T020	PRESS PLATE	84	HS2105T084	HEX NUT
21	HS2105T021	COPPER WASHER	85	HS2105T085	SPRING WASHER
22	HS2105T022	BOLT	86	HS2105T086	FLAT WASHER
23	HS2105T023	VALVE CAP	87	HS2105T087	HEX SCREW
24	HS2105T024	GUIDE SEAT	88	HS2105T088	SIDE COVER GASKET
25	HS2105T025	EXHAUST VALVE KIT	89	HS2105T089	SIDE COVER
26	HS2105T026	HEAD COVER	90	HS2105T090	COPPER WASHER
27	HS2105T027	GASKET	91	HS2105T091-1	MOTOR
28	HS2105T028	ELBOW	92	HS2105T092	HEX NUT
29	HS2105T029	SPRING WASHER	93	HS2105T093	SPRING WASHER
30	HS2105T030	BOLT	94	HS2105T094	FLAT WASHER
31	HS2105T031	COOLER	95	HS2105T095	HEX SCREW
32	HS2105T032	SAFETY VALVE	96	HS3090BT66	PRESSURE SWITCH
33	HS2105T033	EXHAUST NUT	97	HS2065Z64	SAFETY VALVE
34	HS2105T034	EXHAUST ELBOW	98	HS3090BT68	PRESSURE GAUGE(60MM)
35	HS2105T035	HEAD COVER GASKET	99	HS3090BT69	SIX HOLES CONNECTOR

36	HS2105T036	BOLT	100	HS3090BT70	CONNECTOR
37	HS2105T037	SPRING WASHER	101	HS3090BT71	BALL VALVE (1/4)
38	HS2105T038	BOLT	102	HS3090BT72	FEMALE QUICK CONNECTOR
39	HS2105T039	COPPER WASHER	103	HS2105T103-1	MOTOR PULLEY
40	HS2105T040	CYLINDER	104	HS2105T104-1	KEY
41	HS2105T041	1 st PISTONG RING SET	105	HS2105T105-1	BELT
42	HS2105T042	FIRST COMPRESSING RING	106	HS3090BT57	FLAT WASHER
43	HS2105T043	SECOND COMPRESSING RING	107	HS3090BT56	SCREW
44	HS2105T044	THIRD COMPRESSING RING	108	HS2105T108-1	BELT GUARD
45	HS2105T045	OIL RING	109	HS2105T109-1	MOTOR POWER CORD
46	HS2105T046	1 st PISTON	110	HS2105T110-1	CONNECTING POWER CORD
47	HS2105T047	1 st PISTON PIN	111	HS3090BT73	NUT
48	HS2105T048	1 st PIN CLIP	112	HS2105T112	UNLOADING PIPE
49	HS2105T049	CONNECTING ROD COPPER SLEEVE	113	HS2065Z68	ELBOW CONNECTOR
50	HS2105T050	CONNECTING ROD	114	HS2105T114	CHECK VALVE
51	HS2105T051	CONNECTING ROD BEARING	115	HS2105T115	EXHAUST PIPE
52	HS2105T052	NEEDLE	116	HS2105T116-1	TANK
53	HS2105T053	SPRING WASHER	117	HS2105T117	OBSERVATION HOLE PLUG
54	HS2105T054	CONNECTING ROD BOLT	118	HS2105T118	BALL VALVE (3/4)
55	HS2105T055	2 nd PISTONG RING SET	119	HS3090BT81	DRAIN VALVE
56	HS2105T056	FIRST COMPRESSING RING	120	HS2105T120	WHEEL
57	HS2105T057	SECOND COMPRESSING RING	121	HS2070Z76	FLAT WASHER
58	HS2105T058	THIRD COMPRESSING RING	122	HS2070Z79	SNAP SPRING
59	HS2105T059	OIL RING	123	HS3090BT85	STARTER PANEL
60	HS2105T060	2 nd PISTON	124	HS3090BT86	NUT
61	HS2105T061	2 nd PISTON PIN	125	HS3090BT87	SPRING WASHER
62	HS2105T062	BEARING SEAT	126	HS3090BT88	FLAT WASHER
63	HS2105T063	OIL SEAL	127	HS3090BT89	BOLT
64	HS2105T064	BEARING SEAT GASKET	128	HS2105T128	MAGNETIC STARTER